

Thank you for purchasing our Bravo Chassis. We hope that you enjoy your chassis and we think that you'll find it to be high quality and an exceptional value.

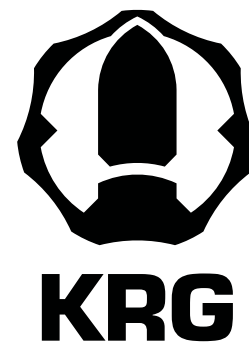

Bravo Chassis for Rem 700 LA

Contents of Package:

- Bravo Chassis partially assembled – accepts CIP-length (3.850”) AICS magazines
- Remington 700:
 - 1ea 1/4-28 x 1.750 socket head screw (accepts 3/16” hex bit)
 - 1ea M6 washer
 - 1ea MOE L2 rail kit
 - 2ea M5 Flat weld nut
 - 1-3 LOP Spacer Set

Installation Instructions:



Safety Warning: Before you attempt any installation, make sure your rifle is unloaded. Also, before starting remove the bolt and magazine from the rifle.

Part I: Remove action from existing chassis/stock

Step 1: Loosen the two screws that hold the action into the stock. Next pull the barreled action out of the stock. You will need to remove the box magazine parts, if present.

Step 2: Turn the chassis upside down! The front action screw is already in place, you will need to remove the o-ring retainer that holds it. This is located inside the inlet area where the action sits. For Remington stocks, two washers are used on the front action screw.

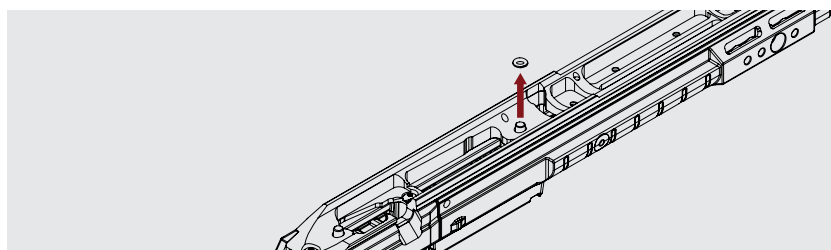

Part II: Install your action into the Bravo Chassis

Step 1: Insert the barreled action into the backbone, tighten the front action screw to finger tight. Front action screw is in place already and captured by forend.

Step 2: With the whole assembly upside down, drop the rear action screw into the hole just behind the trigger guard, turn the screw to engage the threads in the action. Again do not fully tighten. ***Rear action screw on Remington chassis gets one washer.

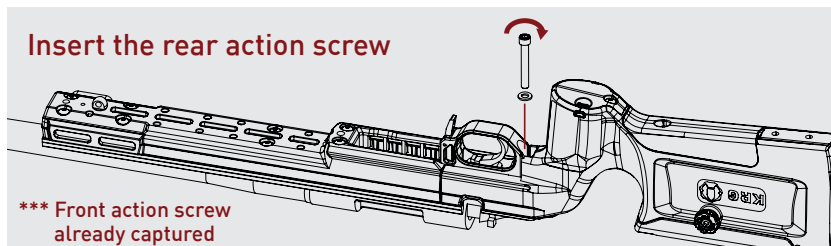

Step 3: Pull the action towards the rear of the stock while holding the stock stationary. This is to seat the action against the recoil lug. A good way is to set the rifle vertical on the buttpad and bounce it on the ground a couple times.

Step 4: Making sure the action is level and not canted to the left or right in the chassis, begin tightening the actions screws starting with the front screw, tightening a little and then moving to the back screw and tightening a little. Keep switching back and forth to ensure even tension until the screws are fully tightened.

Step 5: Torque both screws to 65 in-lbs of torque in an incremental manner, moving back and forth between the two screws until full torque is reached.

Step 6: Tighten the screw just behind the action to about 45 in-lbs AFTER the action screws are fully torque. This screw is only finger tight when you receive the stock. It is meant to be that way.

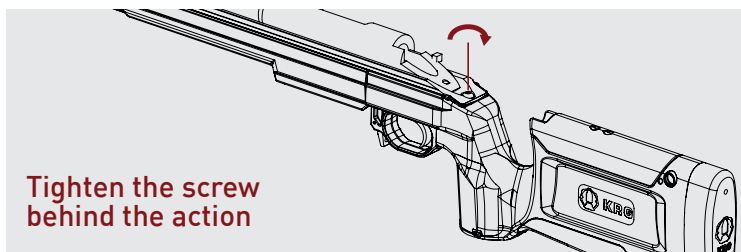

Step 7: Insert a magazine to test for fit, the forend can be moved forward or backward a small amount to adjust the magazine fit. Additionally, the trigger guard can be moved a small amount as well if necessary, this will require removal of the barreled action. Due to the magazine design of the AICS magazine and the magwell of the Bravo, it may be possible to put pressure on the mag and push it up against the bolt. For this reason we do not recommend resting the gun on the magazine when firing.

Time to adjust the stock to fit you! Length of Pull (LOP) Adjustment

Step 1: Remove the buttpad using a 3mm metric hex/allen wrench.

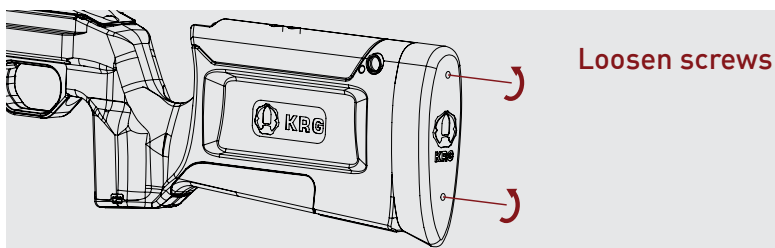

Step 2: Push the installed M5 buttstock mount screws out of the buttstock. Replace these screws with the longer screws, which are long enough to go through your desired amount of spacers. Insert desired quantity of spacers onto the longer screws

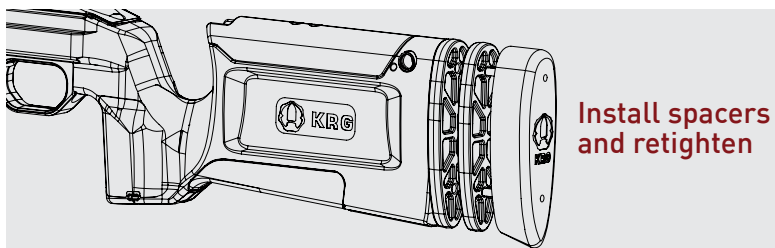

Step 3: Install the buttstock back onto the buttstock stock with the spacers captured between them.

Cheek Height Adjustment

Tool-less cheek height adjustment with a simple return to zero feature

Step 1: Loosen the thumbscrew and move the cheekpiece to your desired position.

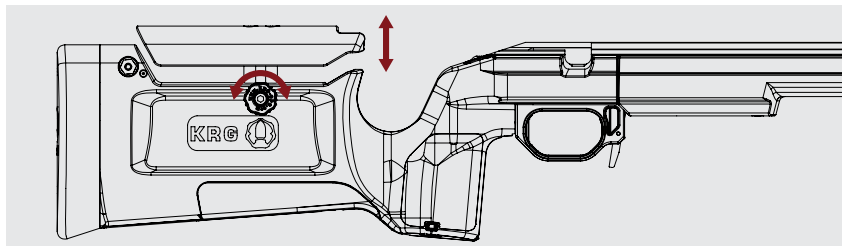

Mounting Options Data

